



3 BEDROOMS OF HIGH STANDING IN THE NEW PROGRAMME LES
FERMES DE L'ALPE · ALPE D'HUEZ



3 BEDROOMS OF HIGH STANDING IN THE NEW PROGRAMME LES FERMES DE L'ALPE



1 129 500€

Recover the VAT of your investment. Please contact us to request the VAT amount.

Fees charged to seller

Information on the risks to which this property is exposed is available on the site
Geohazards: www.georisques.gouv.fr

Réf : 2351-D205

Among the 60 lots in the programme there are no less than 12 3 bedrooms with a living area ranging from 85 to 121 sq.m, this one is 102 sq.m. When you enter the property you will directly access the living room equipped with its open kitchen, we have here a spacious and very bright room thanks to its large balcony of almost 11 sq. m. There is also the first and largest double bedroom with its own shower room. In order to accommodate 4 more people there are of course 2 more double bedrooms, these give access to a terrace of 8 sq. m.

Ski locker included.



LAYOUT

- △ Entrance
- △ Living room
- △ Open fitted kitchen
- △ Balcony
- △ 1 double bedroom ensuite
- △ 1 bathroom
- △ 1 double bedroom with dressing room
- △ 1 double bedroom
- △ 1 separate toilet

ANNEXES

- △ Ski locker



102.49m²



3



1



1



KEY POINTS

- △ Exceptional location
- △ High quality materials
- △ High-end services

AMENITIES



Elevator



Balcony



Terrace



LOCATION



LES FERMES DE L'ALPE

L'Alpe d'Huez

Avenue de l'Eclosé

4 PIECES
Bâtiment D - **D205** - niveau 2

Entrée	5,79
Séjour/Cuisine	33,47
Chambre 1	16,01
Chambre 2	12,94
Chambre 3	10,95
Dress.	4,04
Dgt	4,38
SdB	6,37
SdE	4,47
WC	1,95
Bnd.	2,12

Surface Habitable Totale	102,49 m²
Balcon	11,80
Terrasse	8,64

Plan de repérage - niveau 2



TE - Tableau électrique
GT - Gaine technique
PI - Placard
PF - Porte-fenêtre
F - Fenêtre
Soffite / Faux-plafond
hauteur libre 2.20m

21/02/2020

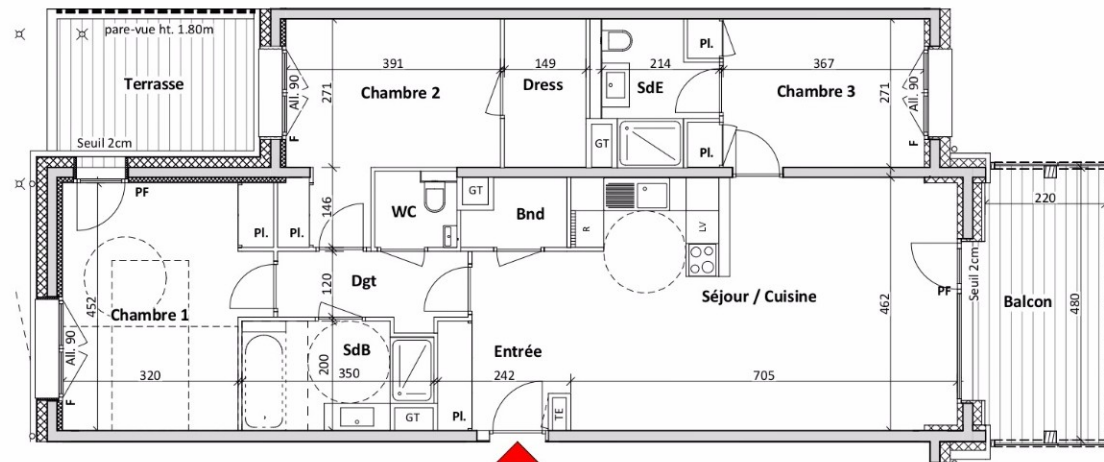

Les surfaces, côtes, gaines, rebords, soffites et faux-plafonds ainsi que l'emplacement des sanitaires ne sont pas tous figurés ou le sont à titre indicatif. Des modifications sont susceptibles d'être

0 01 1 1A 2

PLAN











